

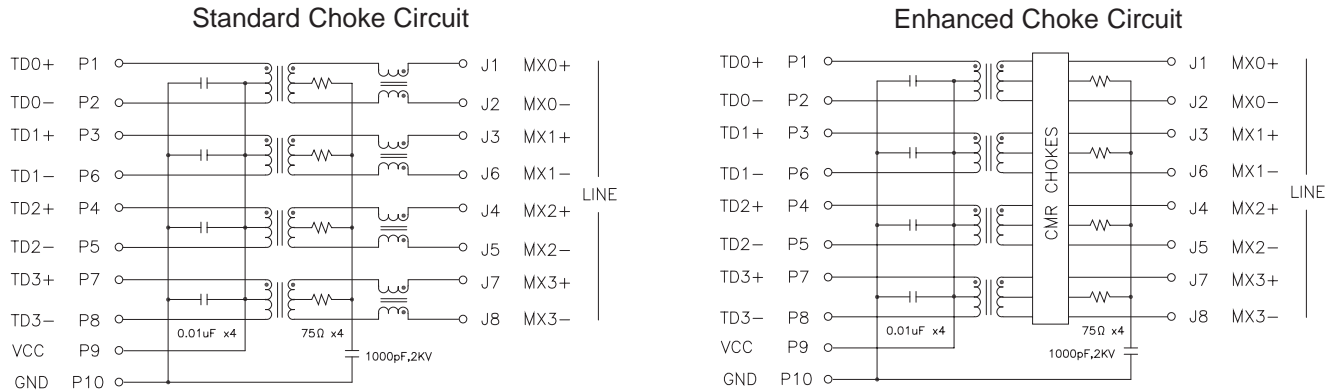

FastJacks™ **HALO**
ELECTRONICS, INC.

Single Level, Gigabit RJ-45 Connectors

HALO Electronics is pleased to offer this new series of small footprint Gigabit single and Ganged FastJack™, integrated connectors. This series is ideal for hi-density switch applications requiring the highest performance in a minimal amount of real estate. HALO's Gigabit FastJacks™ are compatible with all leading silicon vendors' Phy's. Please contact your local HALO Representative for more information.



Electrical Specifications @ 25°C

Operating Temp:	0 to +70°C	Return Loss (min):	
Isolation Voltage:	1,500 Vrms	1-40Mhz	-18dB
OCL (100KHz, 0.1Vrms, 8mA):	350uH min	60Mhz	-14.5dB
CMR (0.1-100MHz):	-40dB typ	80Mhz	-12dB
Insertion Loss (0.1-100MHz):	-1.1dB Max	100Mhz	-10dB
Crosstalk (0.1-100MHz):	-[33-20log(F/100Mhz)]dB typ		

CMR Choke	Port Count		
	Single	1x2	1x4
Standard Choke	HFJ11-1G01E	HFJ12-1G01E	HFJ14-1G01E
Enhanced Choke*	HFJ11-1G02E	HFJ12-1G02E	HFJ14-1G02E

* The Enhanced CMR Choke circuit provides a low impedance path to ground for improved noise immunity performance when needed. Impedance test data available upon request.

Please see individual data sheets for complete electrical specifications.

SINGLE

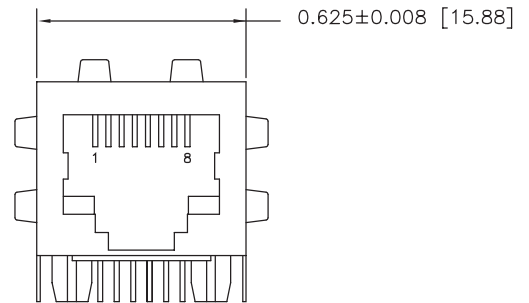
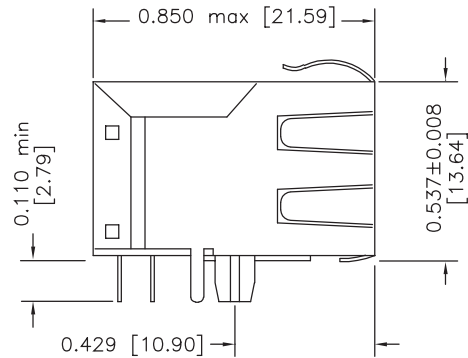
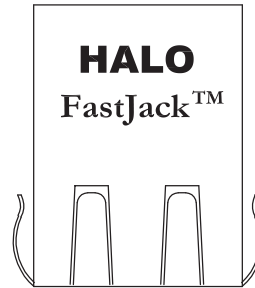

Dimensions: Inch [mm]

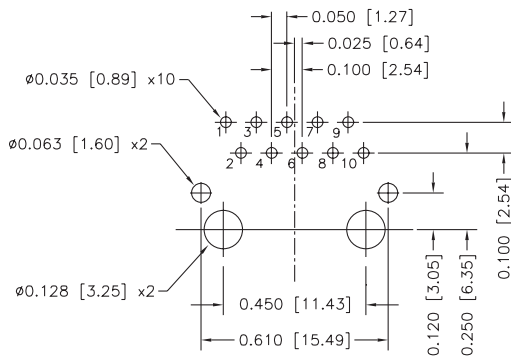

Recommended PCB Pattern

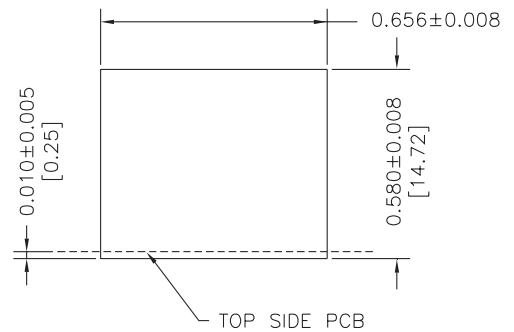

Recommended Panel Cut-out

1x2

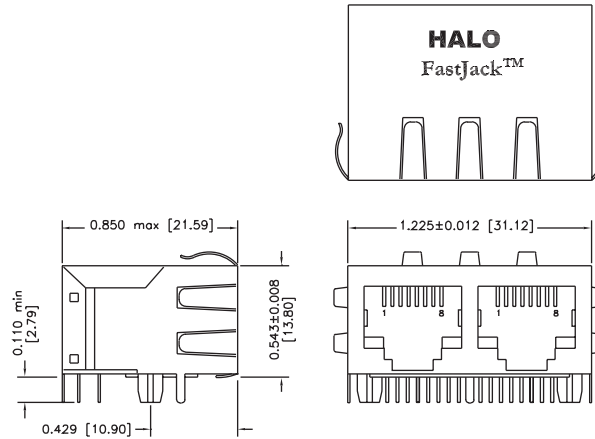

Dimensions: Inch [mm]

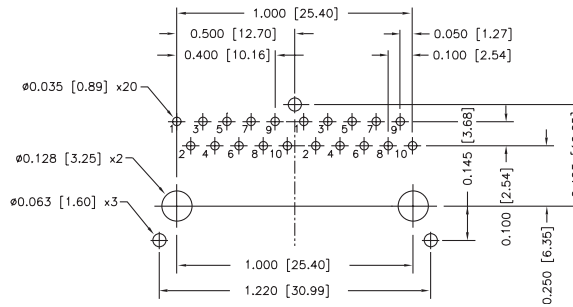

Recommended PCB Pattern

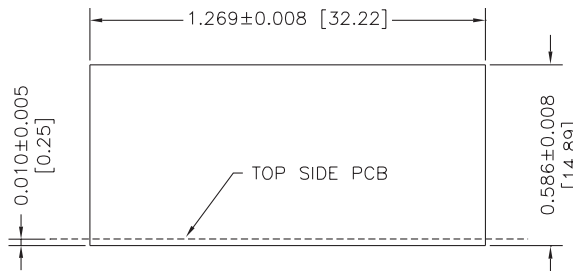

Recommended Panel Cut-out

1x4

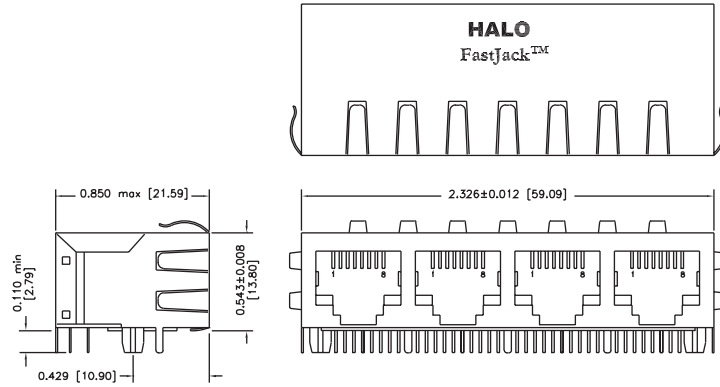

Dimensions: Inch [mm]

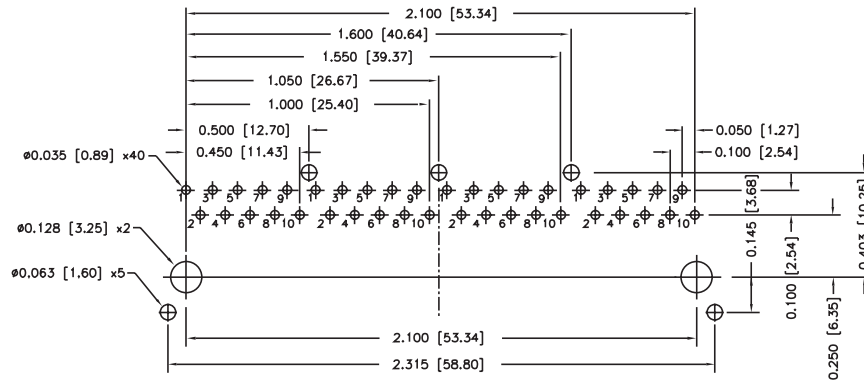

Recommended PCB Pattern

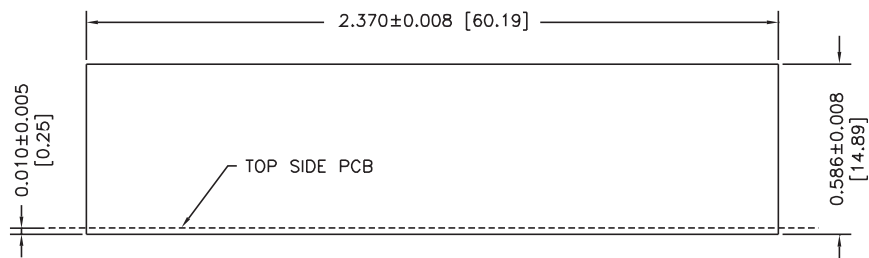

Recommended Panel Cut-out