

Insulator color: Purple (Pantone 2715C)
(See PC99 spec)

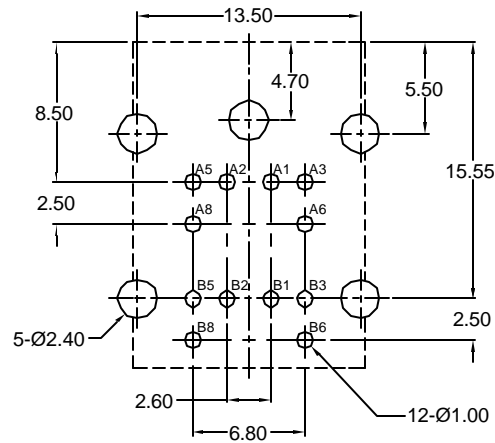
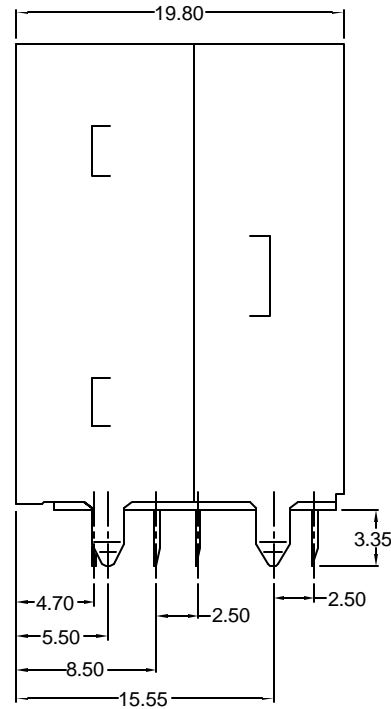
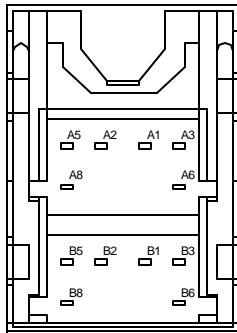

Recommended PCB Layout
(Bottom View)

Material and Finish

Body: PBT Thermoplastic,
UL94V-0 Rated

Color:
Upper Socket: Pantone 3395C, Green
Lower Socket: Pantone 2715C, Purple
(To meet PC99 Spec)

Contacts: Phosphor Bronze
Gold Flash on Contacts,
Tin on Termination

Shield: Brass, Tin plated

Electrical Characteristics

Contact Resistance:
Before Test:
Plug to Terminals: 30 Milliohms Max.
After Test:
Plug to Terminals: 60 Milliohms Max.

Insulation Resistance:
500 Megohms Min.

Dielectric Withstanding Voltage:
500V AC RMS For 1 Minute

Current Rating:
2 Amp at 12V DC

Mechanical Characteristics

Durability Test: 500 Cycles Min.

Insertion Force: 4.5kg max.

Extraction Force: 0.4kg - 3.5kg

Operating Temperature: -25°C to +85°C

PRELIMINARY
PART IN DESIGN
SPECIFICATION SUBJECT TO CHANGE

RoHS COMPLIANT
EU Directive 2002/95/EC



| Tolerances |
|----------------------------|
| X.X ± 0.25 |
| X.XX ± 0.15 |
| Unless Stated Otherwise |

| REV. | DATE | DESCRIPTION | REV. BY | CHK. BY | DRAWN BY | DATE |
|------|---------|-------------|------------|---------|------------|---------|
| A0 | 9/23/05 | New Drawing | R. Aguirre | H. MA | R. Aguirre | 9/23/05 |
| | | | | | | |
| | | | | | | |
| | | | | | | |

KMDGX-6SG/P-S4N1

Stacked Mini-Din, 6P, PC99, RoHS Compliant
Fully Shielded, Gold Contacts, w/Mounting Hole

